

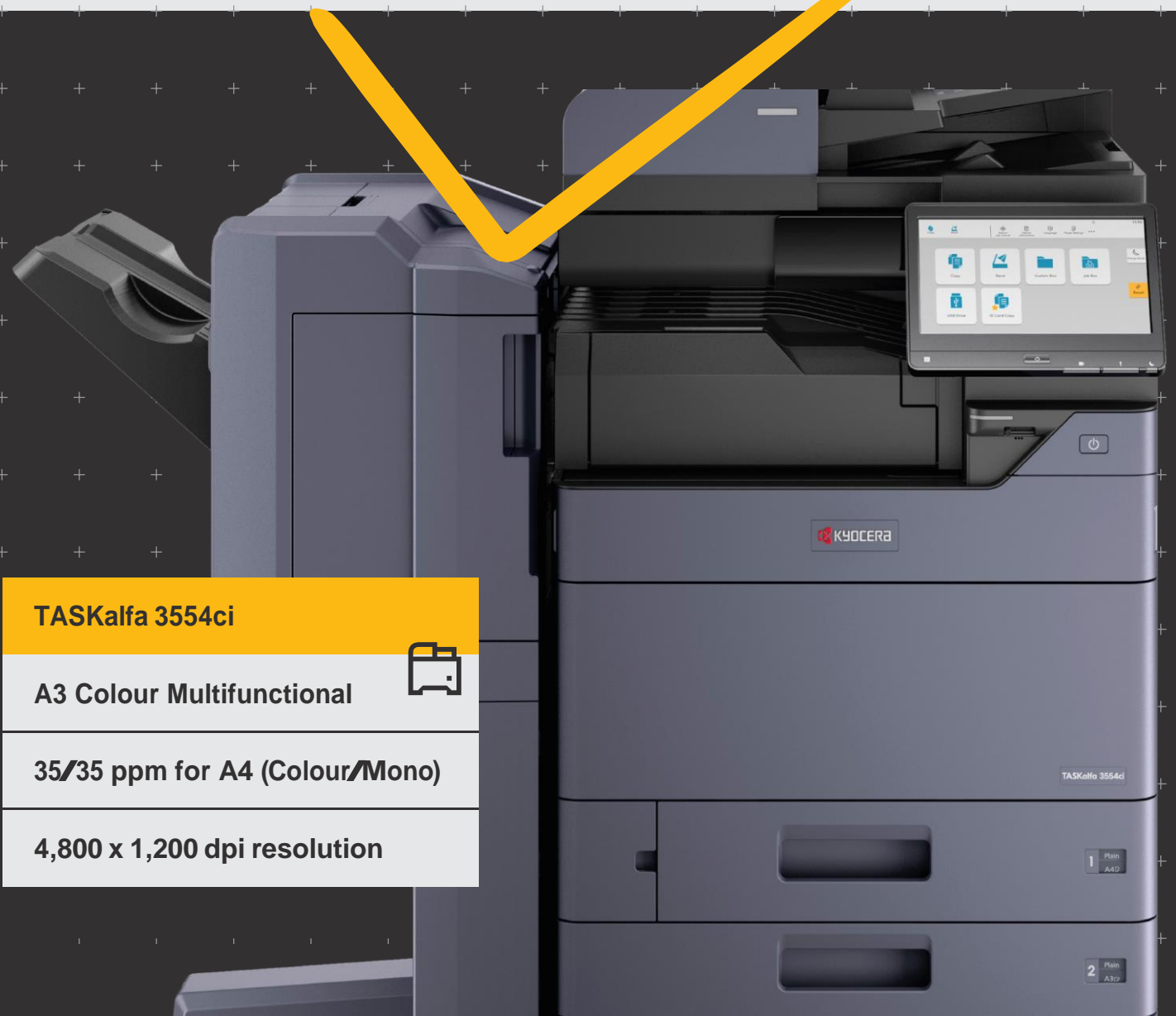

Versatility, Intelligence and Reliability at their best

The TASKalfa 3554ci is the ideal partner for an ever changing business environment featuring reliable performance with reduced maintenance requirements and latest security. Your team can stay focused on their own tasks while this MFP delivers the results they are counting on. The 10.1" touchscreen with our newly designed simple and intuitive user interface will make operating this device as easy as possible.



TASKalfa 3554ci	
A3 Colour Multifunctional	
35/35 ppm for A4 (Colour/Mono)	
4,800 x 1,200 dpi resolution	

KYOCERA

TASKalfa 3554ci

1 Plain A4

2 Plain A3

Specifications

GENERAL

KYOCERA TASKalfa Laser Colour Multifunctional, HyPAS™ solution platform
Operation panel: 256.5 mm (10.1 inch) full-colour touch panel display, speaker for job notification, 15° - 90° swivel mounted
Engine speed: Up to 35/17 pages A4/A3 per minute, Duplex print/copy speed: 35 pages A4 per minute
Resolution: 4800dpi equivalent x 1200dpi (print), 600 x 600 dpi (scan/copy)
Warm-up time: 18 seconds or less
Time to first print: 5.9/7.7 seconds or less in Mono/Colour
Time to first copy: 6.3/8.5 seconds or less in Mono/Colour (DP), Approx. 5.3/ 7.0 seconds or less in Mono/Colour (Platen)
CPU: ARM A53 (Quad Core) 1.6GHz
Memory: Standard 4GB, 32GB SSD, optional 320GB or 1TB
Standard interfaces: USB 3.0 (Super-Speed USB), 4 x USB Host Interface, Gigabit Ethernet (10BaseT/100BaseTX/1000BaseT, IPv6, IPv4, IPsec, 802.3az support), optional Wi-Fi (IEEE 802.11a/b/g/n/ac), 2 eKUIO slots for optional internal print server or for optional fax system, slot for optional Wireless LAN, Slot for optional SD Card, NFC tag
Dimensions (W x D x H): 602 mm x 665 mm x 790 mm
Weight: Approx. 90 kg
Power source: AC 220–240 V, 50/60 Hz
Power consumption: Print Mode: 590W; Copy Mode: 590W; Ready Mode: 40 W; Sleep Mode: 0.5 W
Noise (surface sound pressure level: ISO 7779 measurement distance of 1 meter)
Copying/Printing: 49.0 dB(A) LpA in colour
Stand-by mode: 31.3 dB(A) LpA
Safety standards: TÜV/GS, CE. This unit is manufactured according to ISO 9001 quality standard and ISO 14001 environmental standard.

PAPER HANDLING

All paper capacities quoted are based on paper thickness of max. 0.11 mm. Please use paper recommended by Kyocera under normal environmental conditions.
Input capacity: Multi-purpose 150 sheets, 52 - 300g/m², (Banner 136–163 g/m²), A6R - SRA3 (320 x 450 mm), Banner max. 304.8 x 1,220 mm, Standard universal paper cassette: 2 x 500 sheet, 52 - 300g/m², Upper cassette: A6R up to A4R, lower cassette A6R up to SRA3, Max. input capacity with options: 7,150 sheets A4
Duplex: Standard 60 to 256 g/m², SRA3 to A6R
Output capacity: Standard 500 sheets face down, max. 5,000 sheets

PRINT FUNCTIONS

Controller language: PRESCRIBE
Emulations: PCL6 (PCL5c / PCL-XL), KPD3 (PostScript 3 compatible), PDF Direct Print, XPS Direct Print and OpenXPS
Operating systems: All current Windows operating systems
MAC OS X Version 10.9 or higher Unix, Linux, as well as other operating systems on request
Fonts/barcodes: 93 outline fonts (PCL), 136 fonts (KPD3), 4 fonts (Calibri), 4 fonts (Cambria), 1 Bitmap font, 45 types of one-dimensional barcodes, 1 type of two-dimensional barcode

(PDF417)

Print features: Encrypted PDF 2.0 Direct Print, IPP printing, e-mail printing, WSD print, secure printing via SSL, IPsec, SNMPv3, quick copy, proof and hold, private print, job storage and job management functionality, Super Resolution
Mobile printing support: AirPrint, Mopria, NFC, Direct Wi-Fi (optional), MyPanel and KYOCERA, Mobile Print app for iOS and Android

COPY FUNCTIONS

Max. original size: A3/Ledger
Continuous copying: 1 - 9,999
Zoom range: 25 - 400 % in 1 % steps
Preset magnification ratios: 5 Reductions/5 Enlargements
Exposure mode: Manual: 17 steps
Image adjustments: Text + Photo, Photo, Text, Diagram/Map
Features: Scan-once-copy-many, electronic sort, 2in1, 4in1, image repeat, page numbering, cover mode, booklet copy, interrupt copy, form overlay, margin shift, auto cassette change, skip blank page, ID copy, Handwriting erase and highlight

SCAN FUNCTIONS

Functionality: Scan-to-email, Scan-to-FTP, Scan-to-SMB 3.0, Scan-to-USB Host, Scan-to-box, Network TWAIN, WSD scan (WIA Driver Network)
Scan speed: 200 ipm (300 dpi, A4, duplex, with DP-7160/7170)
Scan resolution: 600, 400, 300, 200 dpi, 256 greyscales per colour
Max. scan size: A3, Ledger
Original recognition: Text, photo, text + photo, Light Text / Fine Line, optimised for OCR
File types: TIFF, PDF, PDF/A, JPEG, Open XPS, Encrypted PDF, High compression PDF, PDF/A-1a/b, PDF/A-2a/b/u, Searchable PDF (option), MS Office file (option)

FAX FUNCTIONS (OPTIONAL)

Compatibility: ITU-T Super G3
Modem speed: Max. 33.6 kbps
Transmission time: Less than 3 seconds (JBIG)
Scanning speed: 2.0 seconds or less
Maximum original size: A3/Ledger, Banner: 1600mm
Compression method: JBIG, MMR, MR, MH
Features: Network faxing, rotate transmission, rotate reception, encrypted transmission and reception, duplex fax reception, memory reception, mailbox, remote diagnostics, polling transmission and reception, broadcast, Optional Internet-fax, dual fax with second fax system 12

CONSUMABLES

Average continuous toner yield in accordance with 5% coverage A4.
TK-8375K Toner Kit: Microfine toner black for 30,000 pages A4
TK-8375C, TK-8375M, TK-8375Y Toner Kits: Microfine toner cyan, magenta, yellow for 20,000 pages A4
Staples: SH-10, 5000 x 3 staples, for BF-730, DF-7100, DF-7120
SH-12, 5000 x 3 staples, for DF-7140
WT-8500: Waste Toner Bottle: 40,000 sheets (in accordance with 5% coverage, b/w : colour = 7:3)

OPTIONS

Fax System 12
Internet Fax Kit (A) AC
Scan Extension Kit (A) AC: Scan to searchable PDF solution (embedded OCR), convert to PDF or MS Office (docx, xlsx, pptx)
DP-7140: (Reversing), 50 sheets, 45–160 g/m² (simplex), 50–120 g/m² (duplex), A5R–A3, Banner up to 1,900 mm
DP-7150: (Reversing), 140 sheets, 35–160 g/m² (simplex), 50–120 g/m² (duplex), A6R–A3, Banner up to 1,900 mm
DP-7160: (one-path duplex scanning), 320 sheets at 50 - 80 g/m², 35–220 g/m² (simplex), 50–220 g/m² (duplex), A6R–A3, Banner up to 1,900 mm
DP-7170: (one-path duplex scanning with ultrasonic sensor), 320 sheets at 50 - 80 g/m², 35–220 g/m² (simplex), 50–220 g/m² (duplex), A6R–A3, Banner up to 1,900mm
DT-730(B): Document tray
PF-7120: Side Deck: 3,000 sheets, A4, 60–300 g/m²
PF-7140: 2 x 500 sheets, 52–300 g/m², A6R–SRA3
PF-7150: 2 x 1,500 sheets, A4, 52–300 g/m², A4, B5, Letter
DF-7100: Inner finisher 500 sheets A4, 52–300 g/m², A6R–SRA3
Stapling up to 50 sheets A4 or 30 sheets A3 at 3 positions
DF-7120: 1,000 sheets A4, 52–300 g/m², A6R–SRA3, Stapling up to 50 sheets A4 or 30 sheets A3 at 3 positions
DF-7140: Main tray: 4,000 sheets A4, Sub tray: 200 sheets A4, 52–300 g/m², A6R–SRA3, Stapling up to 65 sheets A4 or 30 sheets A3 at 3 positions
AK-7110 attachment kit for DF-7120 and DF-7140: 100 sheets, 52–300 g/m², A6R–SRA3, Bridge unit
AK-7110 is required when using a finisher
PH-7C/PH-7D: Punch unit for DF-7120 and DF-7140
2-hole/4-hole/Swedish type, 45–300 g/m², A5R–A3
MT-730(B): MT-730(B) Mailbox sorter for DF-7140
7 bins x 100 sheets A4, 50 sheets A3/B4, 60–163 g/m²
BF-730: Booklet and tri-folding unit for DF-7140, Half-folding: 52–256 g/m², A3, B4, A4R, Booklet: Max. 20 sheets (80 pages, 60–90 g/m²), Non-staple folding: Max. 5 sheets (60–90 g/m²)
Tri-folding: Tri folding : Max 5 sheets (60–120 g/m², A4R), Multi tri-folding: 5 sheets (60–90 g/m²), 3 sheets, (91–120 g/m²)
JS-7100: 100-sheet internal job separator, 52–300 g/m², A6R – SRA3
JS-7110: 250-sheet Inner shift tray, 52–300 g/m², A6R – SRA3
PH-7120: Inner punch unit for inner finisher DF-7100
PH-7130: Inner punch unit for inner finisher DF-7100, Swedish type
HD-15: HDD 320 GB
HD-16: HDD 1 TB
NK-7120: NK-7120 Numeric keypad
UG-33 AC: ThinPrint support
UG-34 AC: Emulation (IBM Proprinter/EPSON LQ-850/LinePrinter)
USB IC Card Reader + Card Authentication Kit (B) AC
IB-37: Wireless Network Interface (USB : 5GHz/2.4GHz)
IB-38: Wireless Network Interface (USB : 2.4GHz)
IB-50: GB-Ethernet board 10 BaseT/100 BaseTX/1,000 BaseT
IB-51: Wireless LAN Interface (802.11b/g/n)
Platen cover Type (E)
CB-7200W: Wooden cabinet
CB-7210M: Metal cabinet

The TASKalfa 3554ci incorporates extremely durable components that guarantee efficient and reliable operation, to meet the demanding requirements of busy office environments. The TASKalfa 3554ci provides effective productivity and maximum flexibility, whilst ensuring minimum impact on the environment.

