

VPL-E Series Data Projectors

VPL-EX100, VPL-EX120, VPL-EX145,
VPL-EX175, VPL-EW130, Data Projectors



3LCD BrightEra™ HDMI

Environmentally conscious, lower total cost of ownership and easy operation

The Sony VPL-E Series data projectors are designed to deliver a lower total cost of ownership and include environmentally conscious features, thanks to a long-lasting lamp design and lower power consumption.

The VPL-EW130 presents clear and dynamic images in native WXGA resolution on a widescreen with a high brightness of 3000 lumens, while the VPL-EX100, VPL-EX120, VPL-EX145, and VPL-EX175 provide high picture quality in native XGA resolution and a high brightness of 2300, 2600, 3100 and 3600 lumens, respectively.

Delivering superb images along with simple operation, the VPL-E Series projectors provide an excellent balance between quality and cost, ideal for use in education, SMEs or corporates.

Features

Cost-efficient, Energy-efficient Design Long-lasting Lamp

By incorporating a newly developed high-performance lamp and advanced lamp-control technology, VPL-E Series projectors deliver an extremely long lamp replacement time of 6,000 hours.*

Lamp and Filter Synchronised Maintenance

When it's time to clean the air filter, a reminder message is displayed on screen. Like the lamp, the air filter has an approximate 6,000-hour cleaning cycle. The filter only needs to be cleaned when the lamp is changed, saving maintenance effort and cost.

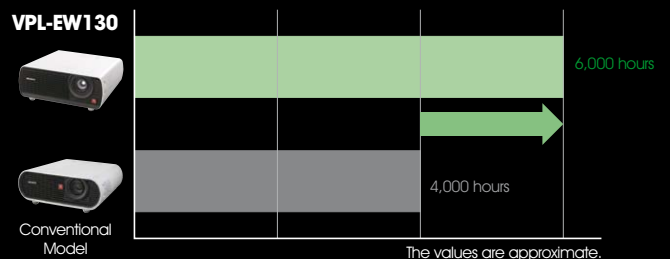

Recommended lamp replacement time

* Approximate recommended period, in low mode.

Features Continued

ECO MODE Key

With a single push of the ECO MODE key on either the projector or the supplied Remote Commander™ unit, users can switch to the ECO setting.

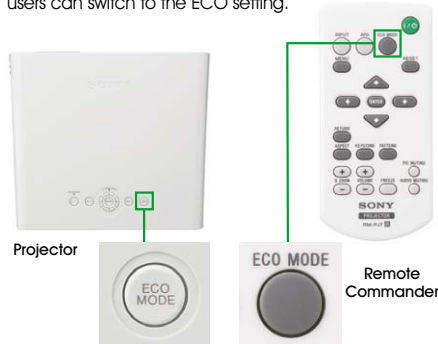

ECO MODE key			ECO Setting
Lamp Mode	High	Standard	Low
Power Saving Mode	Off	Lamp-Off	Standby
Standby Mode	Standard		Low

ECO MODE menu

See Brightness/Lamp Light Output Specifications by Model

Power Saving Mode

If no signal is input for 10 minutes, the projector lamp automatically turns off.

Lower Power Consumption

The VPL-E Series offers remarkably lower power consumption, allowing users to make significant savings on electricity expenses.

Simple Projector Replacement

Flexible installation is possible, without the need to change ceiling mounts, when replacing existing projectors with the VPL-E Series as the XGA models have a standard 1.4 to 1.82 throw ratio, and the WXGA model has a 1.4 to 1.81:1 throw ratio. In addition, all models have a standard 1.3 zoom lens.

High Picture Quality

High Picture Quality and Bright Images

By combining a new generation of inorganic LCD panels that utilise Sony BrightEra™ technology with a 3LCD projection system, the VPL-EX120, VPL-EX145, VPL-EX175, and VPL-EW130 offer high picture quality and brightness.

* BrightEra with Long Lasting Optics is the Sony brand name for a new generation of optical system, which uses a more advanced version of the Sony original BrightEra technology. In addition to adopting LCD panels that have pixels with large aperture ratios and inorganic alignment layers, BrightEra with Long Lasting Optics technology also uses an inorganic layer for polarisation plates to greatly enhance reliability.

3LCD Projection Offers Brilliant Colour Performance

The VPL-E Series adopts a 3LCD projection system incorporating three LCD panels. This system enables each projector to present bright and natural images.



simulated image

WXGA/XGA Resolution

The VPL-EX100, VPL-EX120, VPL-EX145, and VPL-EX175 offer native XGA resolution for high picture quality. XGA resolution of 1024 x 768 contains 60% more pixels compared to SVGA resolution of 800 x 600. As a result, XGA resolution delivers much greater detail and finer images.

Furthermore, the VPL-EW130 can present dynamic images in native WXGA resolution on a widescreen. WXGA resolution allows projection in a wider display range compared to SVGA and XGA resolution. More information can be displayed on the screen.

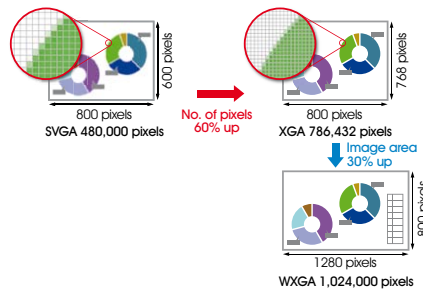

12-bit 3D Gamma Correction

The VPL-E Series incorporates 12-bit 3D gamma correction circuitry to perform highly accurate gamma correction, achieving smoother gradations and a richer grey scale.

I/P Conversion and Film Mode

The video signal processing technology that Sony has incorporated in the VPL-E Series offers I/P conversion and 2-3 pull-down to generate high-quality images with outstanding clarity.

Easy-to-use Functions

Image Freeze

The Image Freeze function can display a freeze frame which allows the presenter to prepare or switch to the next image.

Off and Go

Once a presentation is complete, a VPL-E Series projector can be immediately moved to the next location, simply by turning it off and unplugging the AC power cord – there's no need to wait for the fan to stop.

Front Exhaust

Users can run an optimum presentation even in a quiet environment and participants seated to the side of the projector are not disturbed by hot air and noise.

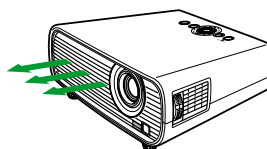

Unique and functional design

Other Features

Auto Keystone Adjustment

Corrects any trapezoidal distortion automatically.

Picture (Audio) Muting

Mutes the image/audio.

6 Picture Modes

Selectable six picture modes according to the picture source.

Picture Modes			
Mode	Description	Brightness	Brightness Mode*
Dynamic	Emphasises the contrast in producing a 'dynamic and vivid' picture	★★★★	High / Standard
Standard	Makes the picture more natural and well balanced	★★★	Standard / ECO
Game	Select for viewing games with vibrant colour	★★	ECO
Living	Select for viewing sports, music and digital video camera picture	★★	ECO
Cinema	Select for viewing film-like picture	★	ECO
Presentation	Makes the picture bright suitable for presentations	★★★★★	High

*Recommendation only, environment conditions can vary

Security Pack

Security lock (password and mechanical), security bar, and panel key lock.

Direct Power On/Off

Direct power control using the circuit breaker on the switch board.

High Altitude Mode

For projector operation at high altitude.

Network and Control

Controls and monitors projector status compatible with various control systems.



Dimensions

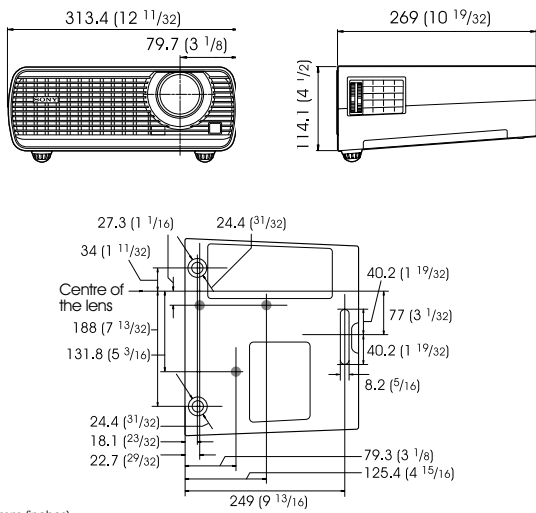

Optional Accessories

LMP-E211
Projector Lamp
(for replacement)



PAM-200
Ceiling Mount



Connector Panels

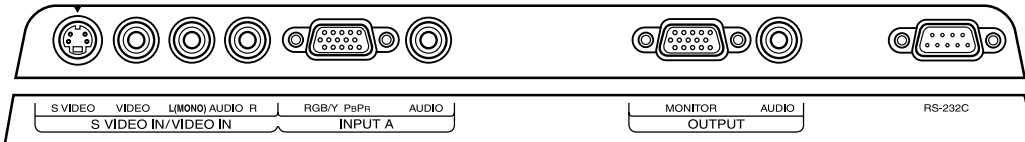

VPL-EX100

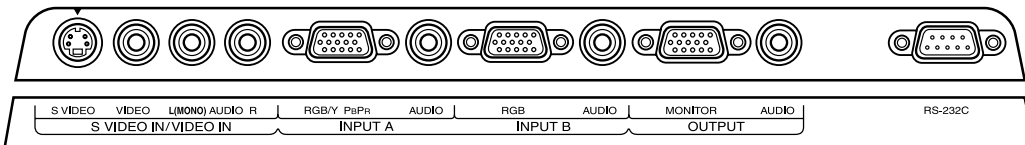

VPL-EX120

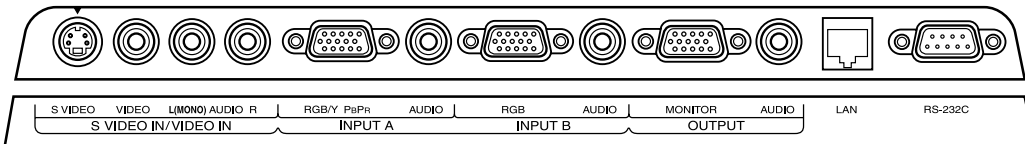

VPL-EX175

VPL-EX145

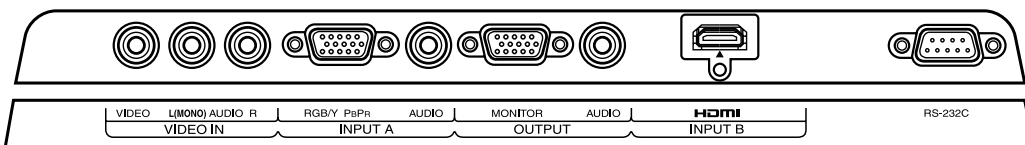

VPL-EW130

All Sony Professional's business projectors sold into the EU, Norway and Switzerland come supplied with a 3 year PrimeSupport pack. This offers unique services and benefits over and above standard warranty:-

3 Years Cover

Freephone telephone helpdesk support (00800 7898 7898) in 5 languages. Collection, repair and return anywhere in EU, Norway and Switzerland. In addition, optional PrimeSupport Plus packs can be purchased which can further enhance the 3 year support to give extra peace of mind:-

- A 2 year extension of the standard 3 year PrimeSupport to give long-term assurance of expert support, technical assistance and repairs for 5 years from purchase date.
- Provision of a loan unit for 3 or 5 years cover to ensure minimal impact to the customer's business in case of product failure.
- Cover for a lamp failure throughout the 3 year PrimeSupport term for customers who don't want to have any unexpected running costs.



Technical Specifications

Specifications		VPL-EX100	VPL-EX120	VPL-EX145	VPL-EX175	VPL-EW130
Display system		3 LCD system				
Display device	Size of effective display area	0.63" (16.0 mm) x 3, Aspect ratio: 4:3	0.63" (16.0 mm) x 3, BrightEra, Aspect ratio: 4:3			0.59" (15.0 mm) x 3, BrightEra, Aspect ratio: 16:10
	Number of pixels	2,359,296 (1024 x 768 x 3) pixels				3,072,000 (1280 x 800 x 3) pixels
Projection lens	Zoom	Manual (Approx. 1.3 x)				
	Focus	Manual				
Light source		High-pressure mercury lamp 210 W type				
Recommended lamp replacement time*1		3000 H / 4500 H / 6000 H (Lamp mode: High / Standard / Low)				
Filter cleaning cycle		Max. 6000 H*1 / Same time as the lamp replacement is recommended				
Screen size		30" to 300" (0.762 m to 7.62 m)				25" to 200" (0.635 m to 5.08 m)
Light output (Lamp mode: High / Standard / Low)		2300 lm / 1800 lm / 1500 lm	2600 lm / 2100 lm / 1700 lm	3100 lm / 2500 lm / 2000 lm	3600 lm / 2700 lm / 2200 lm	3000 lm / 2300 lm / 1800 lm
Colour light output (Lamp mode: High / Standard / Low)		2300 lm / 1800 lm / 1500 lm	2600 lm / 2100 lm / 1700 lm	3100 lm / 2500 lm / 2000 lm	3600 lm / 2700 lm / 2200 lm	3000 lm / 2300 lm / 1800 lm
Contrast ratio (full white / full black)*2		2200:1	2500:1	4000:1	4000:1	2600:1
Speaker		1 W x 1 (monaural)		10 W x 1 (monaural)		1 W x 1 (monaural)
Displayable scanning frequency	Horizontal	14 kHz to 93 kHz				19 kHz to 92 kHz
	Vertical	47 Hz to 93 Hz				48 Hz to 92 Hz
Display resolution	Computer signal input	Maximum input signal resolution: 1600 x 1200 (resizing display), Panel display resolution: 1024 x 768 pixels				Maximum input signal resolution: 1400 x 1050 (resizing display) Panel display resolution: 1280 x 800 pixels
	Video signal input	NTSC, PAL, SECAM, 480/60i, 576/50i, 480/60p, 576/50p, 720/60p, 720/50p, 1080/60i, 1080/50i				
Colour system		NTSC3.58, PAL, SECAM, NTSC4.43, PAL-M, PAL-N, PAL60				
Keystone correction		Vertical: Max. +/- 30 degrees*3				
OSD language		20-languages (English, Dutch, French, Italian, German, Spanish, Portuguese, Turkish, Polish, Russian, Swedish, Norwegian, Japanese, Simplified Chinese, Traditional Chinese, Korean, Thai, Vietnamese, Arabic, Persian)				
Computer and video signal input/output	INPUT A	RGB / Y PB PR input connector: Mini D-sub 15-pin (female), Audio input connector: Stereo mini jack				
	INPUT B	-	RGB input connector: Mini D-sub 15-pin (female), Audio input connector: Stereo mini jack			HDMI™
	S VIDEO IN	S video input connector: Mini DIN 4-pin, Audio input connector: Pin jack (x2) (shared with VIDEO IN)				-
	VIDEO IN	Video input connector: Pin jack, Audio input connector: Pin jack (x2) (shared with S VIDEO IN)				Video input connector: Pin jack, Audio input connector: Pin jack (x2)
	OUTPUT	Monitor output connector*4: Mini D-sub 15-pin (female), Audio output connector*5: Stereo mini jack (variable out)				
Other signal input/output		RS-232C connector: D-sub 9-pin (female)				
Operating temperature (Operating humidity)		0°C to 40°C / 32°F to 104°F (35% to 85% (no condensation))				0°C to 40°C / 32°F to 104°F (20% to 80%; no condensation)
Storage temperature (Storage humidity)		-20°C to +60°C / -4°F to +140°F (10% to 90% (no condensation))				-10°C to 60°C / 14°F to 140°F (20% to 80%; no condensation)
Power requirements		AC 100 V to 240 V, 3.3 A to 1.3 A, 50 Hz / 60 Hz				
Power consumption	AC 100 V to 120 V	300 W / 265 W / 235 W		320 W / 275 W / 245 W		290 W / 240 W / 205 W
	AC 220 V to 240 V	290 W / 255 W / 225 W		310 W / 265 W / 235 W		275 W / 225 W / 190 W
Standby mode power consumption	AC 100 V to 120 V	8 W / <1.0 W (Standby mode: Standard / Low)		9 W / <1.0 W (Standby mode: Standard / Low)		3 W / <1.0 W (Standby mode: Standard / Low)
	AC 220 V to 240 V	10 W / <1.0 W (Standby mode: Standard / Low)		11 W / <1.0 W (Standby mode: Standard / Low)		3 W / <1.0 W (Standby mode: Standard / Low)
Heat dissipation	AC 100 V to 120 V	1023 BTU		1091 BTU		990 BTU
	AC 220 V to 240 V	989 BTU		1057 BTU		940 BTU
Outside dimensions		W 313.4 x H 114.1 x D 269 mm (W 12 11/32 x H 4 1/2 x D 10 19/32 in) (without protrusion)				
Mass		3.2 kg / 7 lb 0.88 oz		3.3 kg / 7 lb 4.4 oz		3.2 kg / 6 lb 15 oz
Supplied accessories		RM-PJ7 Remote Commander (1), Lithium Battery: CR2025 (1), Mini D-sub 15-pin cable (1), Lens Cap (1), Operating Instructions (1), Quick Reference Manual (1), AC power cord (1)			-	
		Carrying case (1)				

*1: The figures are the expected maintenance time and not guaranteed. They will depend on the environment or how the projector is used. *2: The value is average. *3: Depends on resolution. *4: From INPUT A/INPUT B (INPUT B is available only for the VPL-EX175/EX145/EX120). *5: Works as an audio switcher function. From current channel only. Not available in standby.

© 2011 Sony Corporation. All rights reserved. Reproduction in whole or in part without written permission is prohibited. Features and specifications are subject to change without notice. The values for mass and dimension are approximate. "SONY" and "make.believe", "BrightEra" and "Remote Commander" are trademarks of Sony Corporation. Trademark PULink is a trademark applied for trademark rights in Japan, the United States of America and other countries and areas. HDMI, the HDMI logo, and High-Definition Multimedia Interface are trademarks or registered trademarks of HDMI Licensing LLC. All other trademarks are the property of their respective owners.

Distributed by

About Sony Professional

Sony Professional is the leading supplier of AV/IT solutions to businesses across a wide variety of sectors including, Media and Broadcast, Video Security and Retail, Transport & Large Venue markets. It delivers products, systems and applications to enable the creation, manipulation and distribution of digital audio-visual content that add value to businesses and their customers. With over 25 years' experience in delivering innovative market-leading products, Sony Professional is ideally placed to deliver exceptional quality and value to its customers. Sony's Professional Services division, its systems integration arm, offers its customers access to the expertise and local knowledge of skilled professionals across Europe. Collaborating with a network of established technology partners, Sony Professional delivers end to end solutions that address the customer's needs, integrating software and systems to achieve each organisations' individual business goals. For more information please visit www.pro.sony.eu

HCT_10377_UK_04/2011

